



LIFE-Nature-Projekt „Swabian Danube Valley“
www.donaual-life-natur.de

Approaches to support nature-oriented grazing in cooperation with farmers

Dipl.-Biol. Martin Königsdorfer, Projektmanager
www.donaual-aktiv.de
koenigsdorfer@dongaual-aktiv.de

- 1. Natural Basics of the [Swabian Danube Valley](#)**
- 2. General Conditions Of Landuse**
- 3. Approaches to support nature-oriented grazing in cooperation with farmers**
- 4. Summary**



„Swabian Danube Valley“

upper course of the Danube is an important station of the european bird-flyway

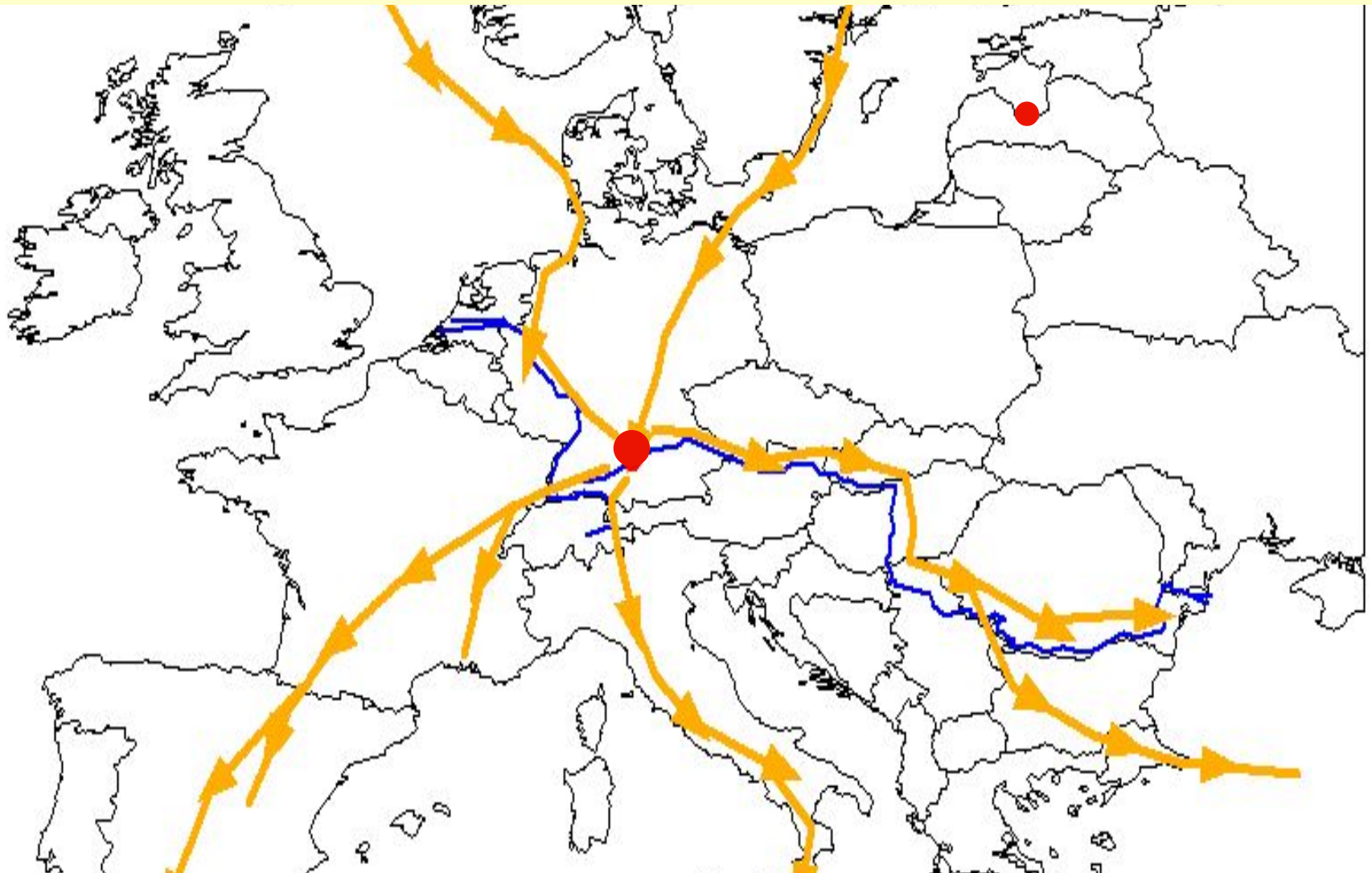

**40.000 ha wide, open plain
with only few settlements
and small traffic system**

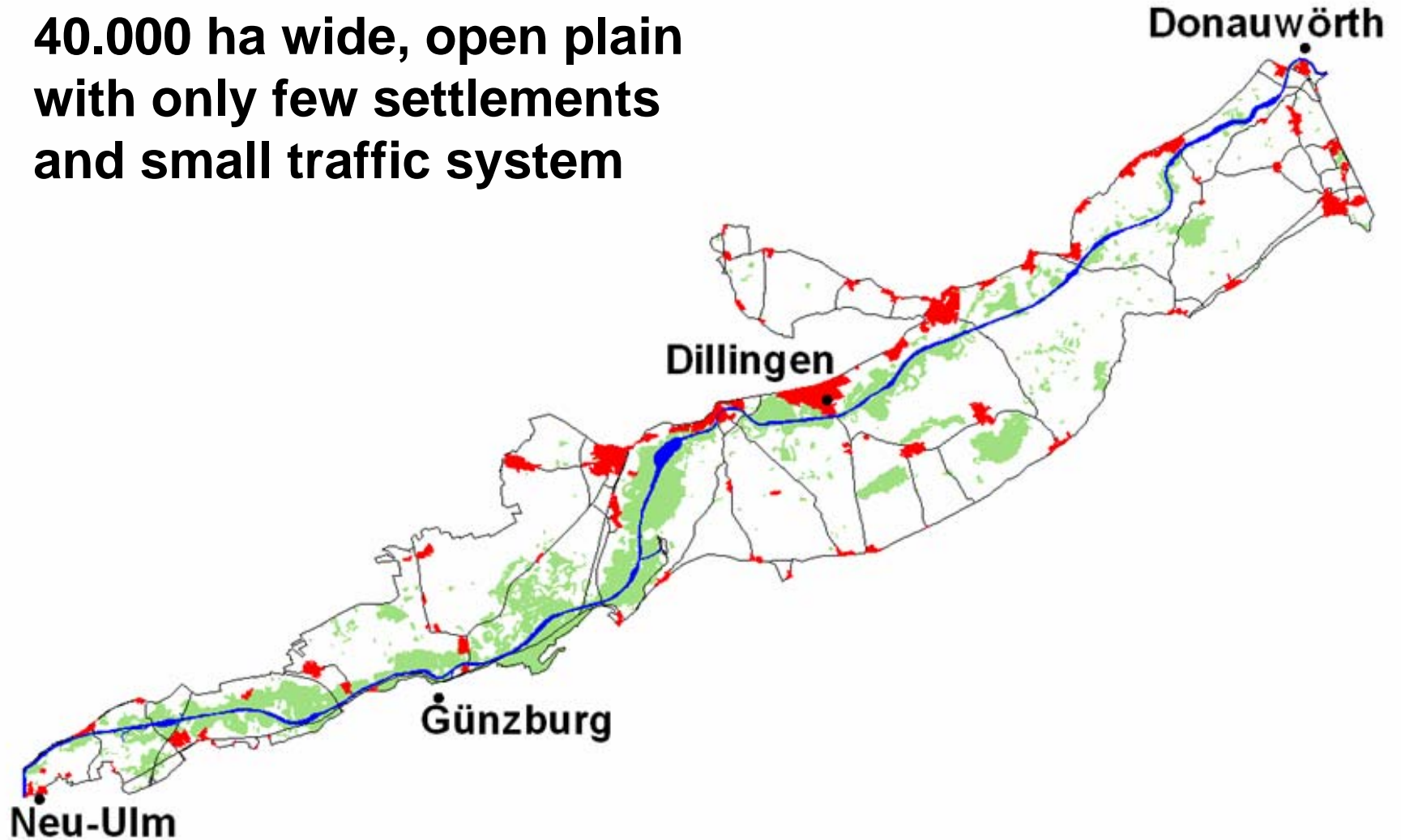

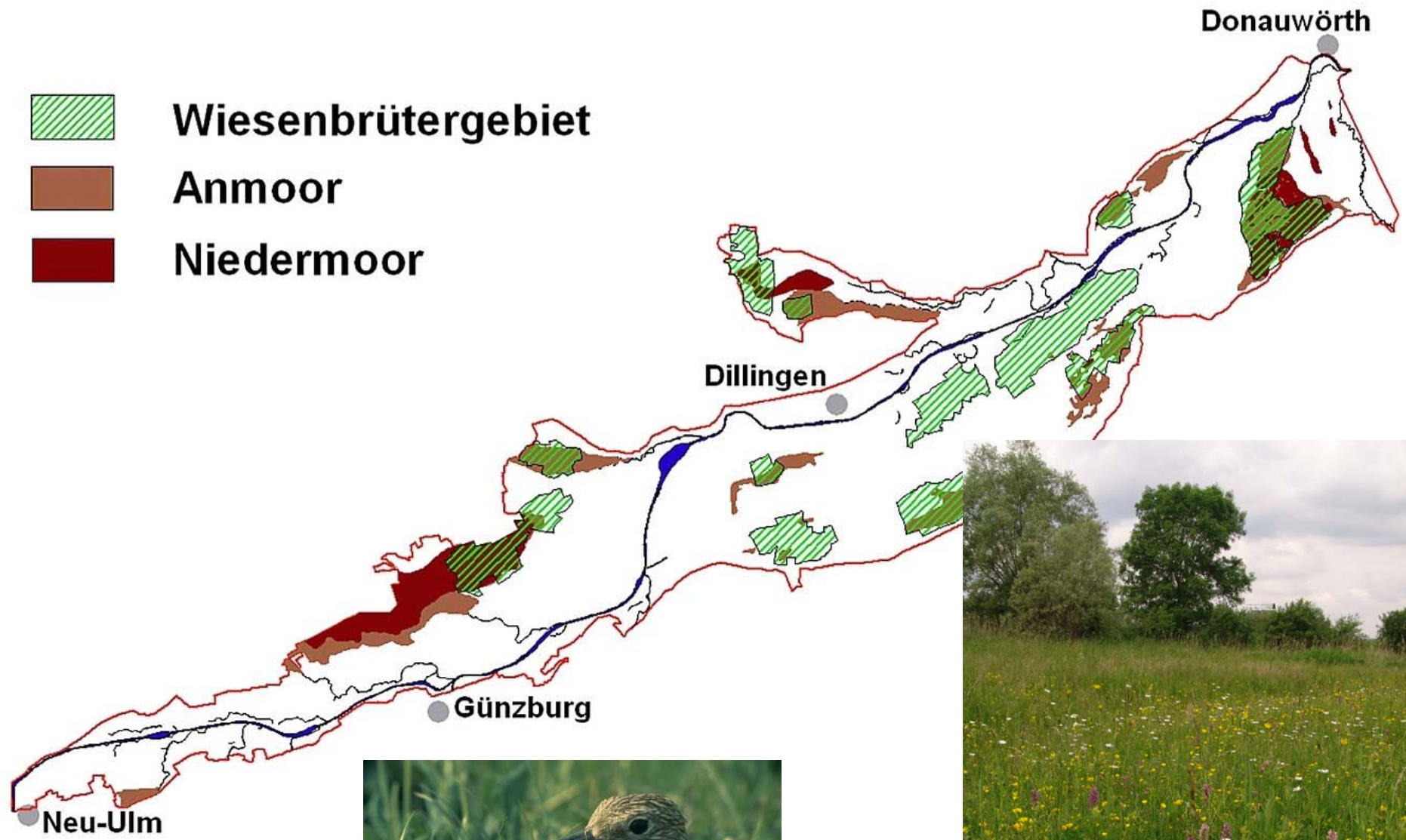



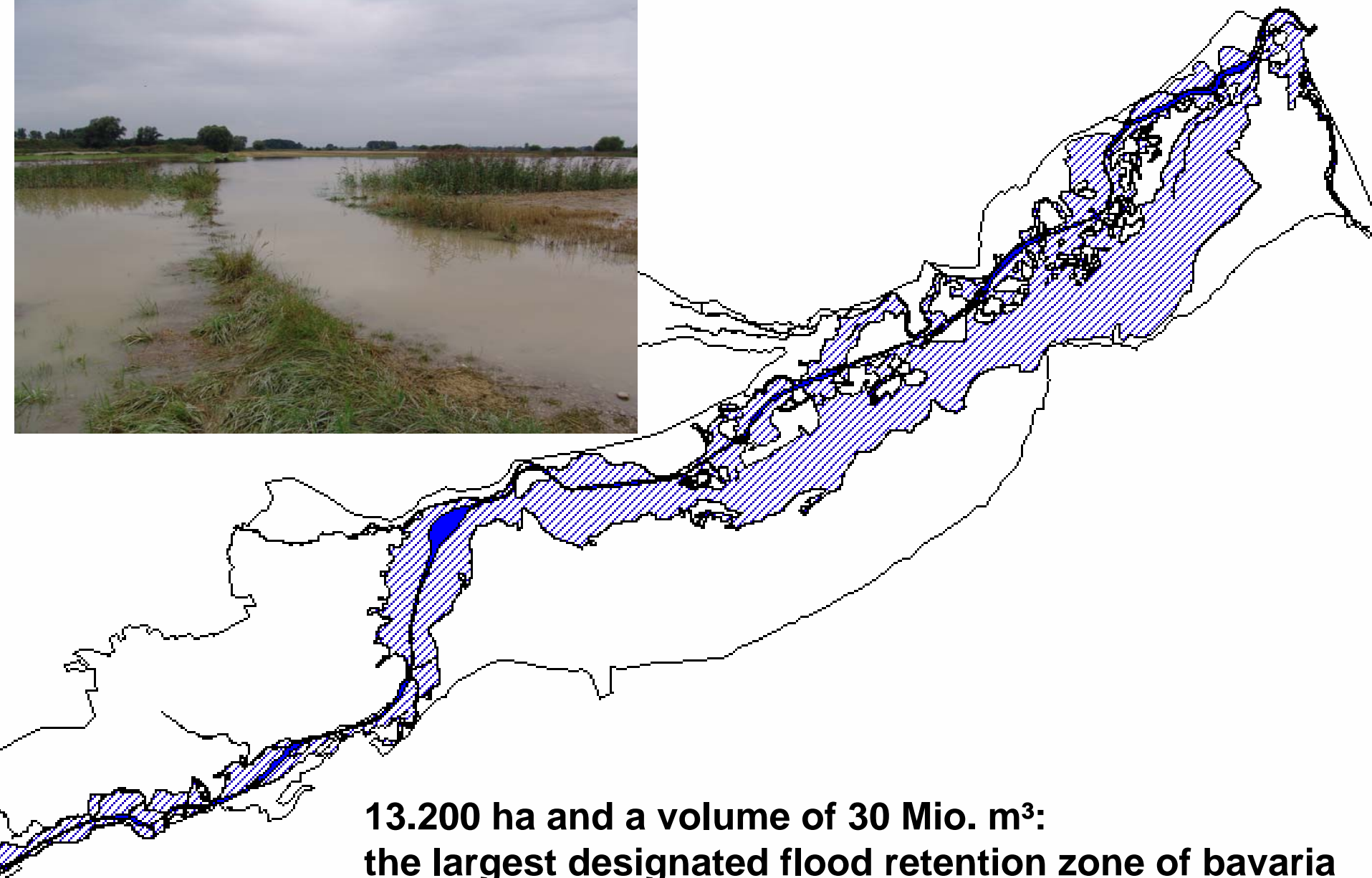

**13.200 ha and a volume of 30 Mio. m³:
the largest designated flood retention zone of bavaria**

Bird Protection Area (SPA)



**Excellent function as rest- and breeding-area in the South of Central Europe:
Total 260 bird species, 151 species are breeding**



2. General Conditions Of Landuse

- share of meadows in the first half of 20. century over 80%
- share of meadows nowadays about 15% (in SPAs about 35%)

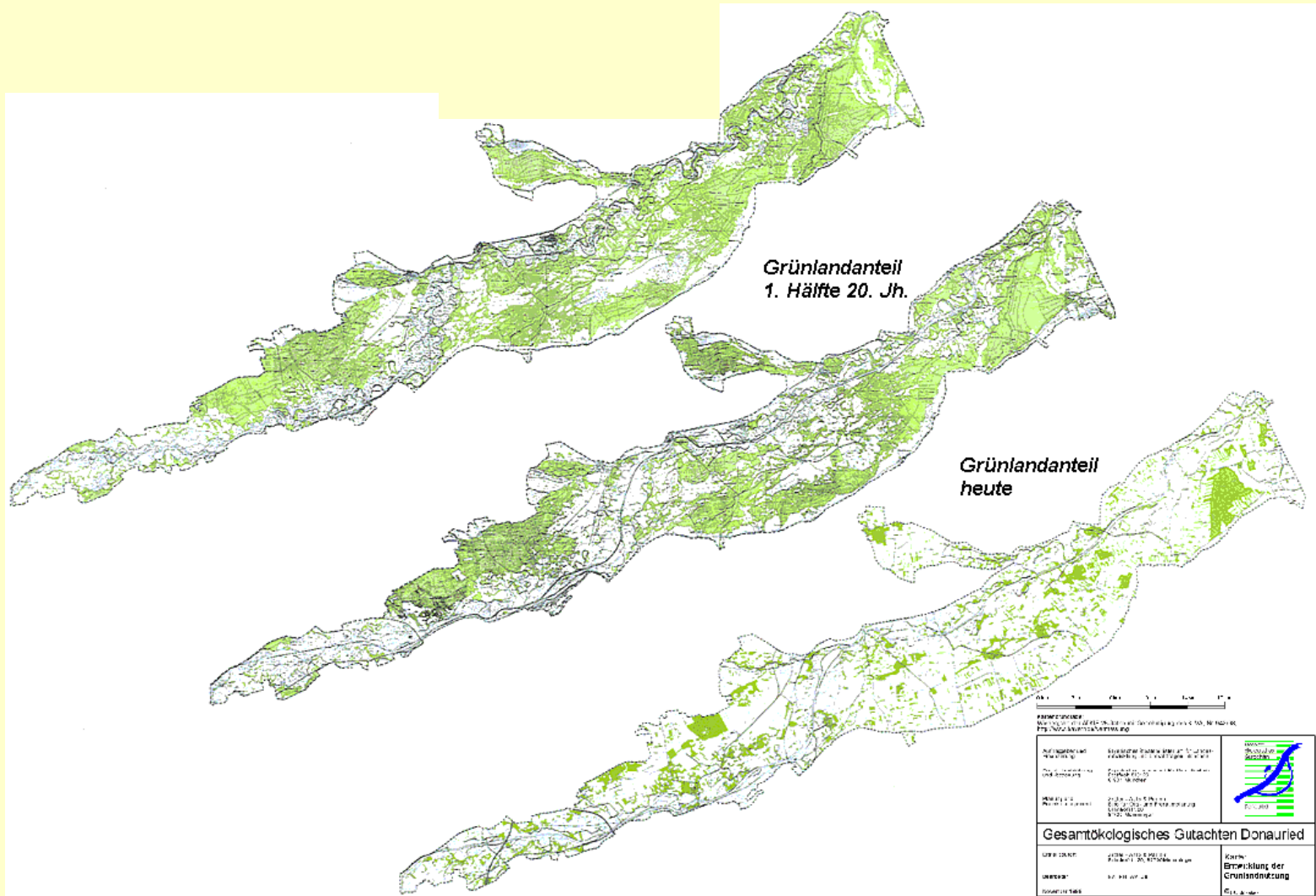

- **Intensification of meadows: from 1-2 cuts for hay to 4-5 cuts for silage**
- **meadows are going back, because of the „Biogasboom“: 2.000 €/ha for maize**
- **agrar-environmental-programms: meadows are supportet between 100 €/ha and 950 €/ha (mowing after 15.9., without fertilize and manual work) – meadows can` t compete with arable land**

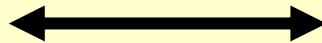

Approaches to support nature-oriented grazing in cooperation with farmers

How can the farmers be motivated to switch to grazing?

- models for grazing must be economical interesting and competitive to arable land
- Experience and knowhow by the farmer
- consolidated areas: min. 20 ha

Solution:

1. consolidation of farmland by the administration of rural development
2. Basic investment: preparation for a natural development (little natural pools and grooves) and grazing (fences, huts) by government or municipal organisation.
3. lease or sale by reduced price to the farmers. Conditions: only grazing and a limit of 1,2 GV/ha

Win-Win-Situation:

Nature-conservation: high biodiversity, save use without overheads

Watermanagement: adjusted landuse in floodplains

Farmer: economical, consolidated pastures; production of high valued beef

Constitute „Grazing Land Swabian Danube Valley“

20 farmers take part

Grazing area: 275 ha

Number of cows: 375

Number of races: 9

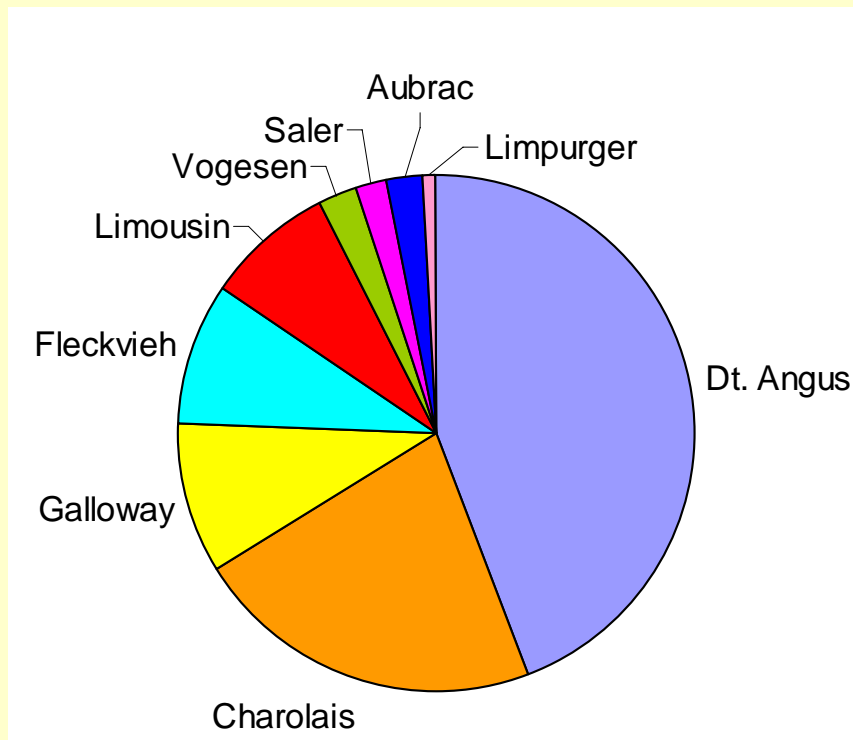

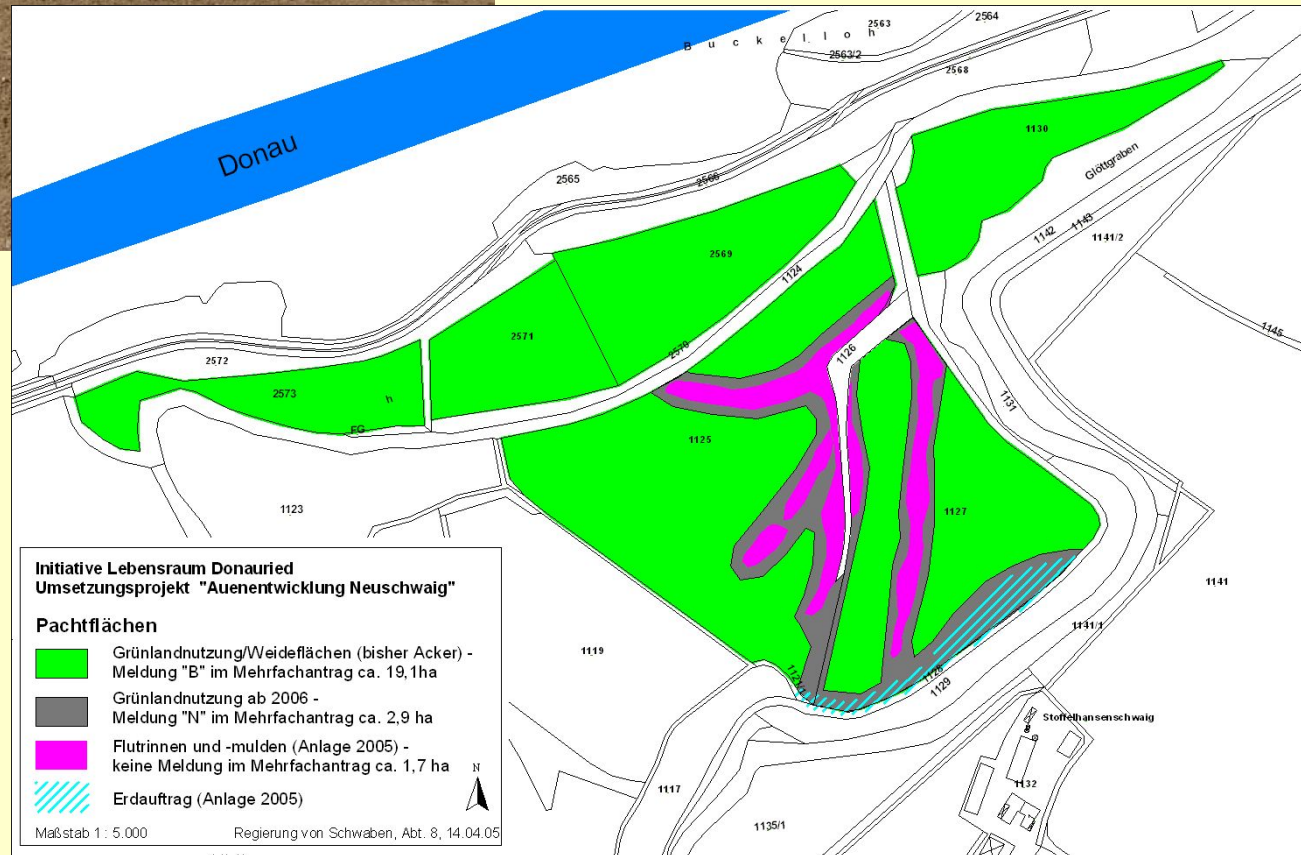

**Initiative Lebensraum Donauried
Umsetzungsprojekt "Auenentwicklung Neuschwaig"**

Pachtflächen

- Grünlandnutzung/Weideflächen (bisher Acker) -
Meldung "B" im Mehrfachantrag ca. 19,1ha
- Grünlandnutzung ab 2006 -
Meldung "N" im Mehrfachantrag ca. 2,9 ha
- Flutrinnen und -mulden (Anlage 2005) -
keine Meldung im Mehrfachantrag ca. 1,7 ha
- Erdauftrag (Anlage 2005)



Maßstab 1 : 5.000

Regierung von Schwaben, Abt. 8, 14.04.05



4. Summary

- Swabian Danube Valley has developed from a meadow-region to arable land
- Agrar-Environmental-Programms can't stop this trend
- Approach for solution:

Initiatives for grazing with consolidation of pastures (min. 20 ha)

lease or sale by reduced price to the farmer

beef-marketing in a high value-sector